

**RODAIR**  
DIV. OF RODRIGUE METAL LTD.

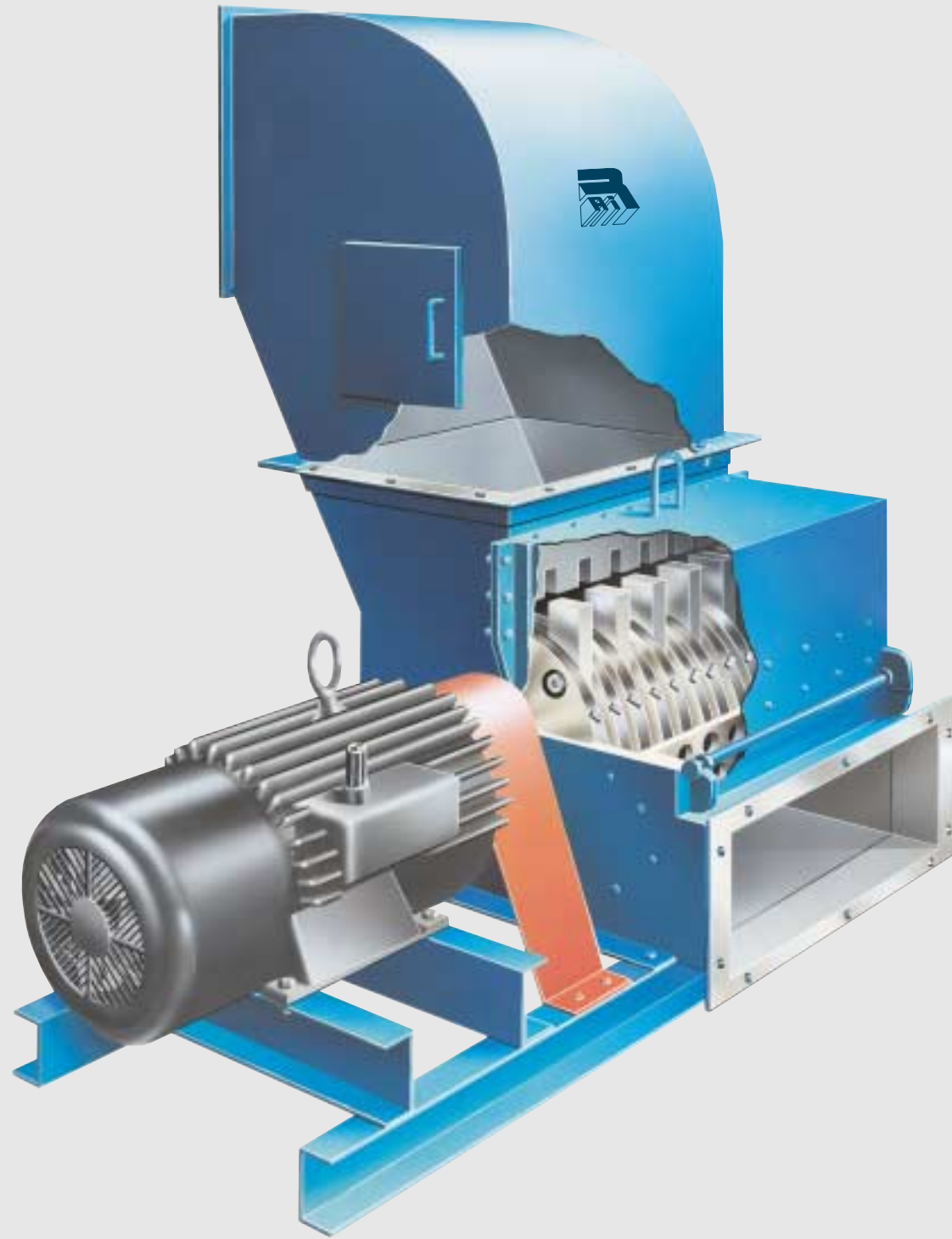

# HAMMER HOG

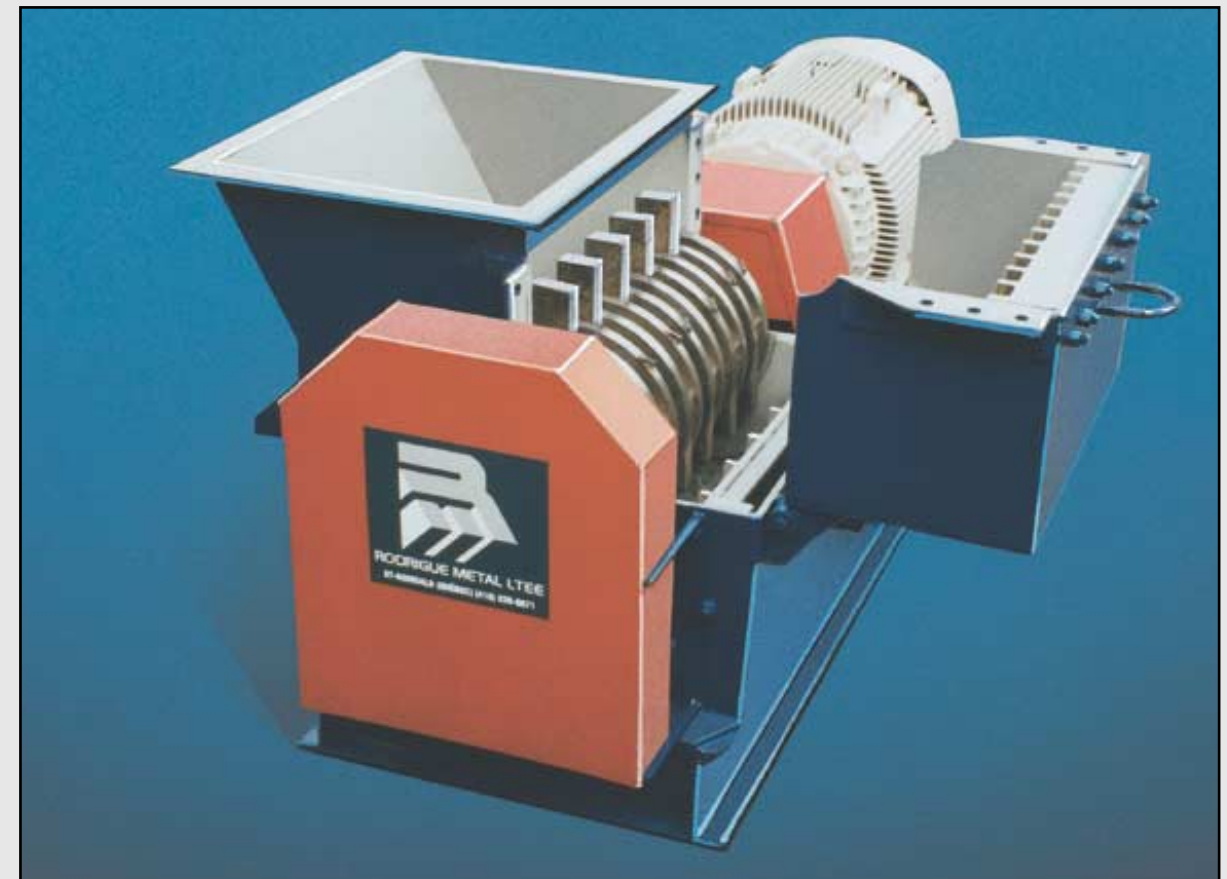

- The easy-to-open cover allows for convenient mechanical inspection and quick replacement of the hammers or calibration screen.

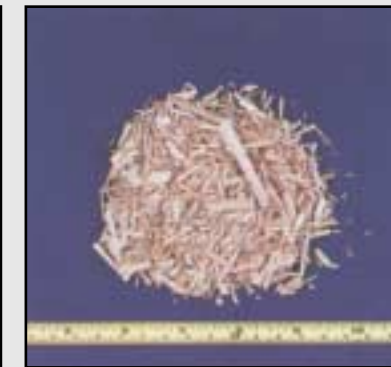

- Rodrigue Metal's hogs allow you to obtain the particle size that is best suited to your needs.

\* The characteristics and the dimensions are subject to change without prior notice.

11-01 PRINTED IN CANADA



**RODAIR**  
DIV. OF RODRIGUE METAL LTD.

1890, 1<sup>ère</sup> Rue,  
Saint-Romuald  
(Québec) Canada  
G6W 5M6  
E-mail : [rodair@rodriguemetal.com](mailto:rodair@rodriguemetal.com)  
Internet : [www.rodriguemetal.com](http://www.rodriguemetal.com)  
Tel.: (418) 839-0400  
Fax: (418) 839-0201

**DISTRIBUTED BY :**

\* This pamphlet may not be reproduced without the written authorization of Rodrigue Métal Ltd.

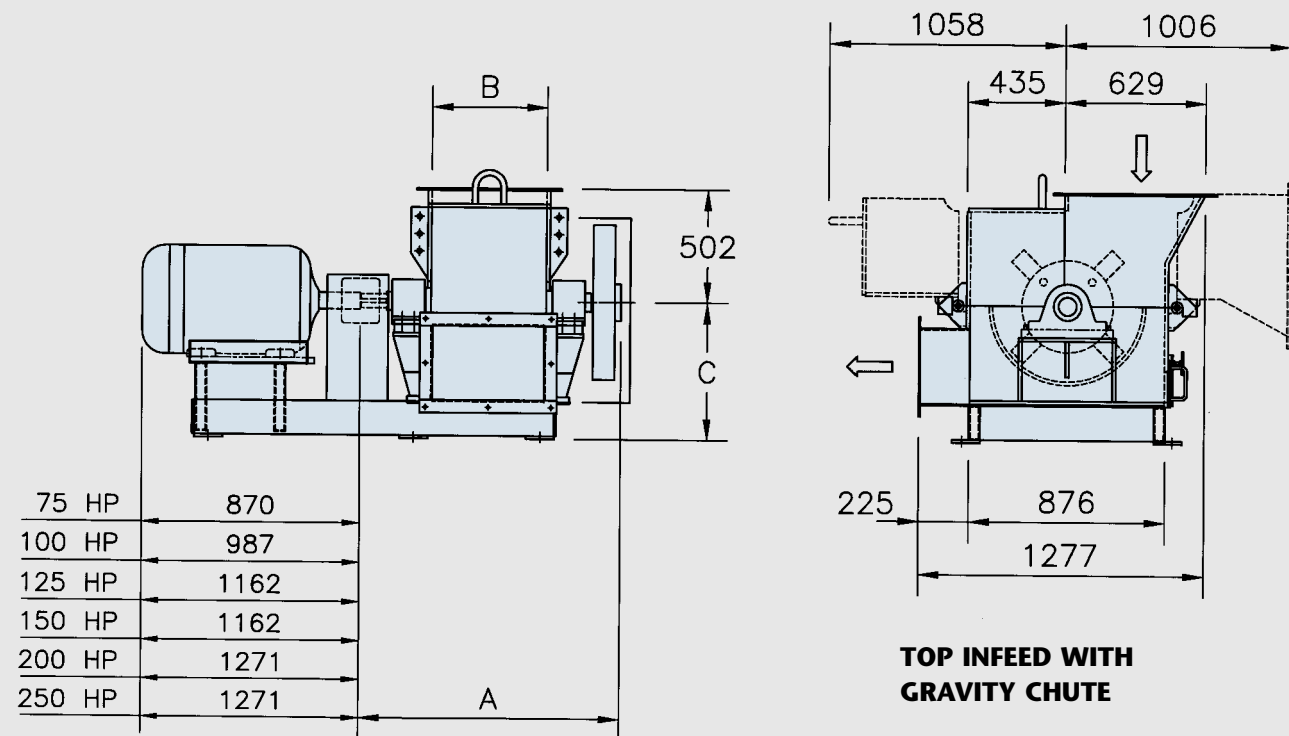

**TOP INFEED WITH GRAVITY CHUTE**

MODEL	DIMENSIONS INFEED OPENING	DIMENSIONS (mm)			WEIGHT LBS	MOTOR H.P.
		A	B	C		
LV 205-14	597 X 514	1187	514	603	3700	75 - 100
LV 308-22	597 X 774	1449	774	654	4500	125 - 150
LV 410-30	597 X 1038	1711	1038	654	5300	150 - 200
LV 513-38	597 X 1300	1973	1300	654	6100	200 - 250

**SERIAL : LV**

- MOTOR 1800 RPM
- WEIGHT DOES NOT INCLUDE MOTOR

**CONSTRUCTION :**

- Heavy-duty welded steel casing
- Rotor with «reversible» hammers mounted on bearings (2)
- Steel screen with openings calibrated according to the desired particle size
- Easy-to-remove wear parts
- Adjustable air intake
- Direct coupling to the motor

**SPECIFICATIONS :**

The choice of a hog depends on the following:

- Capacity (lbs/hr)
- Desired particle size
- Species of residue to be grinded
- Humidity
- Size of residues (length, width, thickness)
- Type of feeding (continuous, automatic, manual)

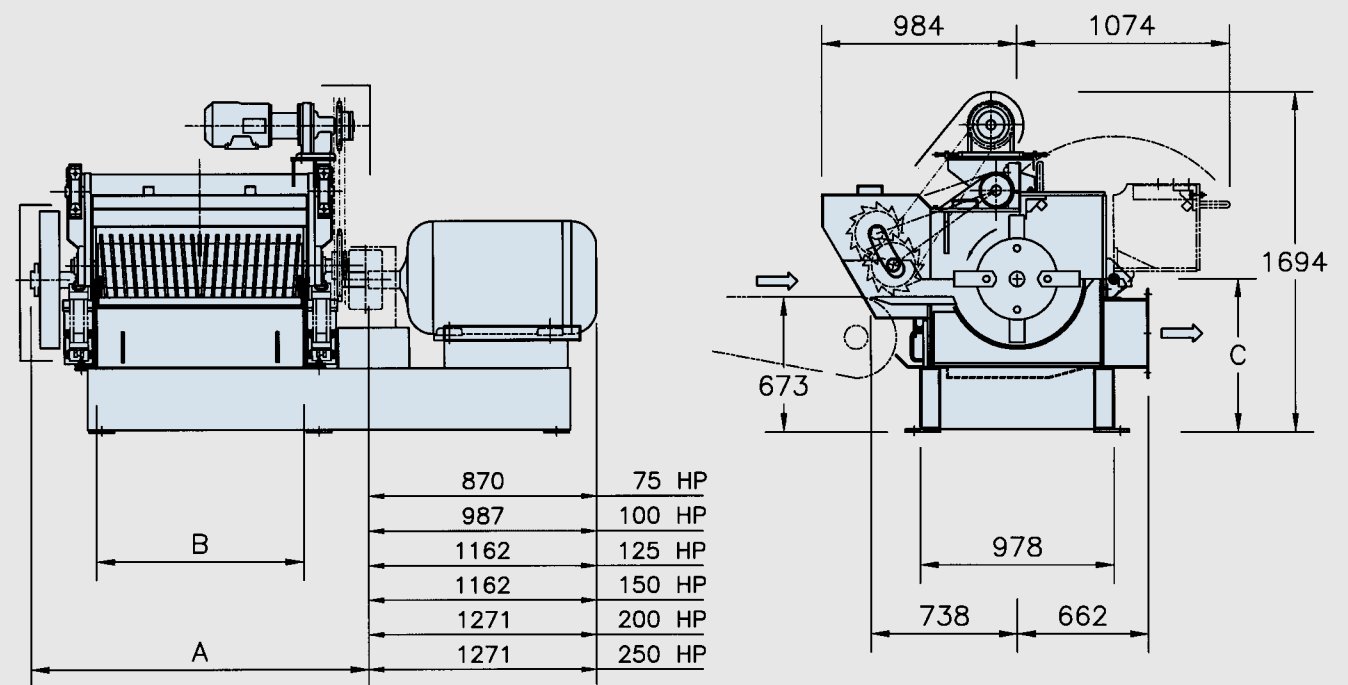

**HORIZONTAL INFEED WITH HOLD DOWN ROLL MOTORIZED**

MODEL	DIMENSIONS INFEED OPENING	DIMENSIONS (mm)			WEIGHT LBS	MOTOR H.P.
		A	B	C		
LH 205-14	163 X 514	1187	514	762	5500	75 - 100
LH 308-22	163 X 774	1449	774	762	6300	125 - 150
LH 410-30	163 X 1038	1711	1038	762	7100	150 - 200
LH 513-38	163 X 1300	1973	1300	762	7900	200 - 250

**SERIAL : LH**

- MOTOR 1800 RPM
- WEIGHT DOES NOT INCLUDE MOTOR

**APPLICATIONS :**

- Hardwood
- Softwood
- Others according to recommendations
- Not recommendable: fibrous residues

**OPTIONAL EQUIPMENT :**

- Infeed chute
- Electric motor
- Amperage detector (feed control)
- Pneumatic or mechanical recovery system
- Other custom-designed models (20 to 50 hp.)

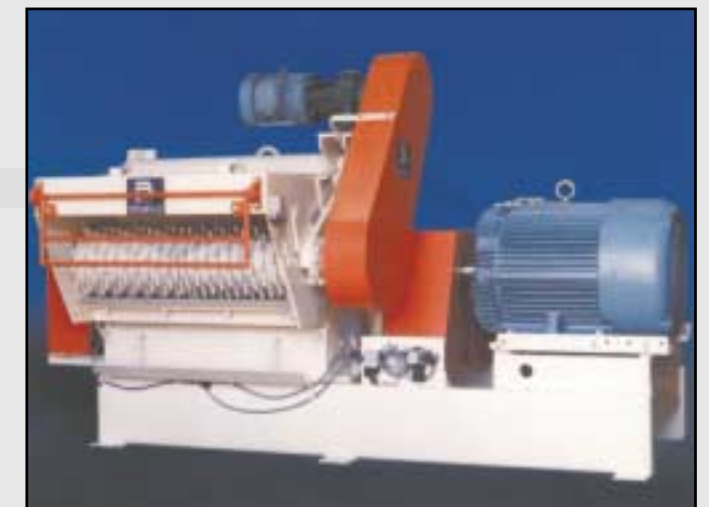

\* The characteristics and the dimensions are subject to change without prior notice.

\* The characteristics and the dimensions are subject to change without prior notice.